BUILDING
on the past...



BELIEVING
in the future...

LONG RANGE PLAN

ST. PAUL'S EPISCOPAL CHURCH

IN THE CITY OF WILMINGTON

THE EPISCOPAL DIOCESE OF EAST CAROLINA

FEBRUARY 6, 2022

*Open doors. Open hearts. Open hands.
We will welcome all to live God's mission, teach Christ's love and
transform our community by the power of the Holy Spirit.*



UPPER LEVEL

0 10' 20' 40'

NORTH

MAIN LEVEL

0 10' 20' 40'

NORTH

LOWER LEVEL

0 10' 20' 40'

NORTH

EXISTING CONDITIONS PLAN

ST. PAUL'S EPISCOPAL CHURCH, WILMINGTON, NORTH CAROLINA

WKWW Architects Charlotte, North Carolina

PRINCESS ST.

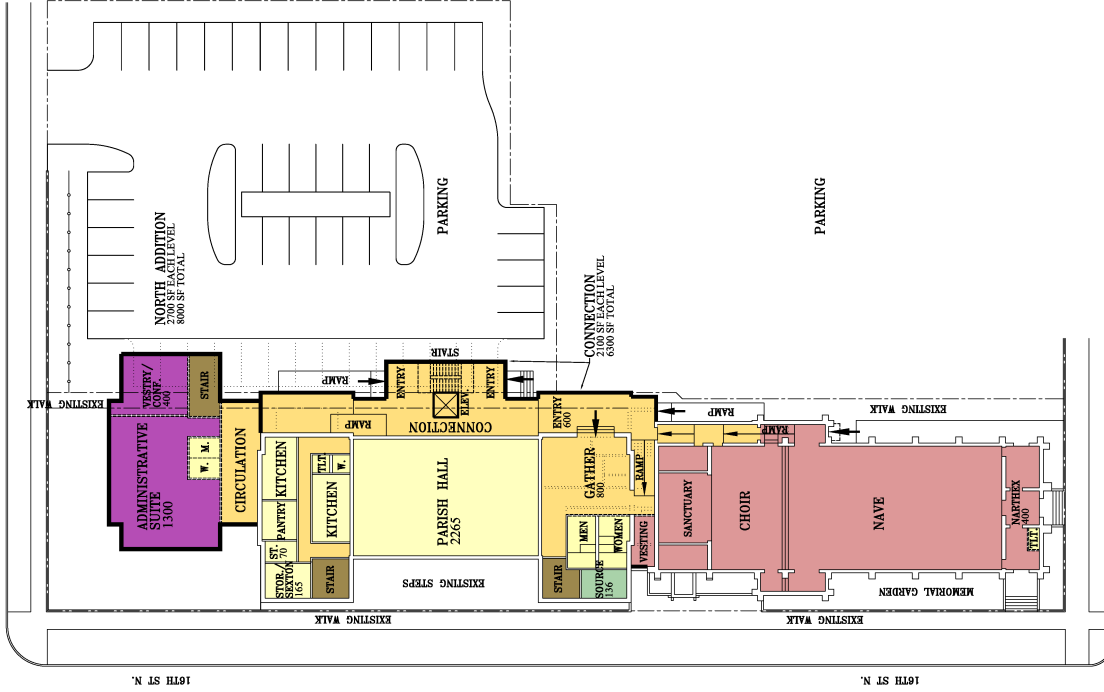

MARKET ST.

MAIN LEVEL

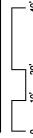

LOWER LEVEL

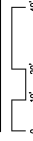

UPPER LEVEL

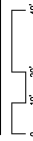

LONG RANGE PLAN

ST. PAUL'S EPISCOPAL CHURCH, WILMINGTON, NORTH CAROLINA

WKWW Architects Charlotte, North Carolina

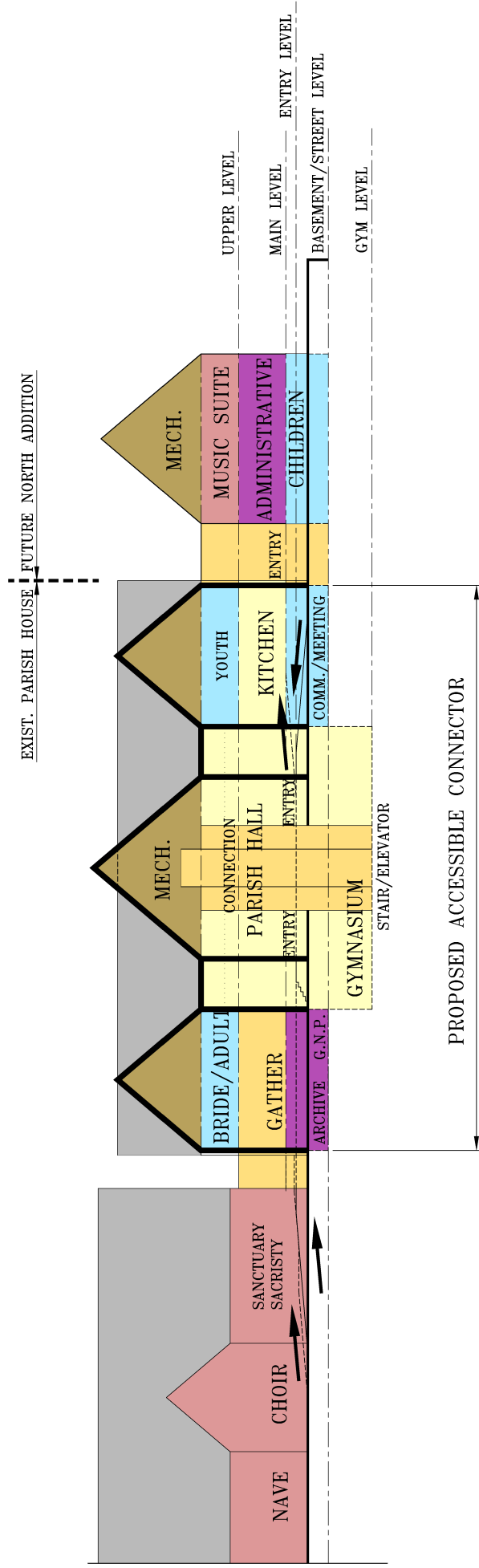

VERTICAL 'ELEVATION' VIEW LONG RANGE PLAN

ST. PAUL'S EPISCOPAL CHURCH, WILMINGTON, NORTH CAROLINA
 WKWW Architects Charlotte, North Carolina



PHASE I CAMPUS ENHANCEMENTS

ST. PAUL'S EPISCOPAL CHURCH, WILMINGTON, NORTH CAROLINA

WKWW Architects Charlotte, North Carolina

PRINCESS ST.

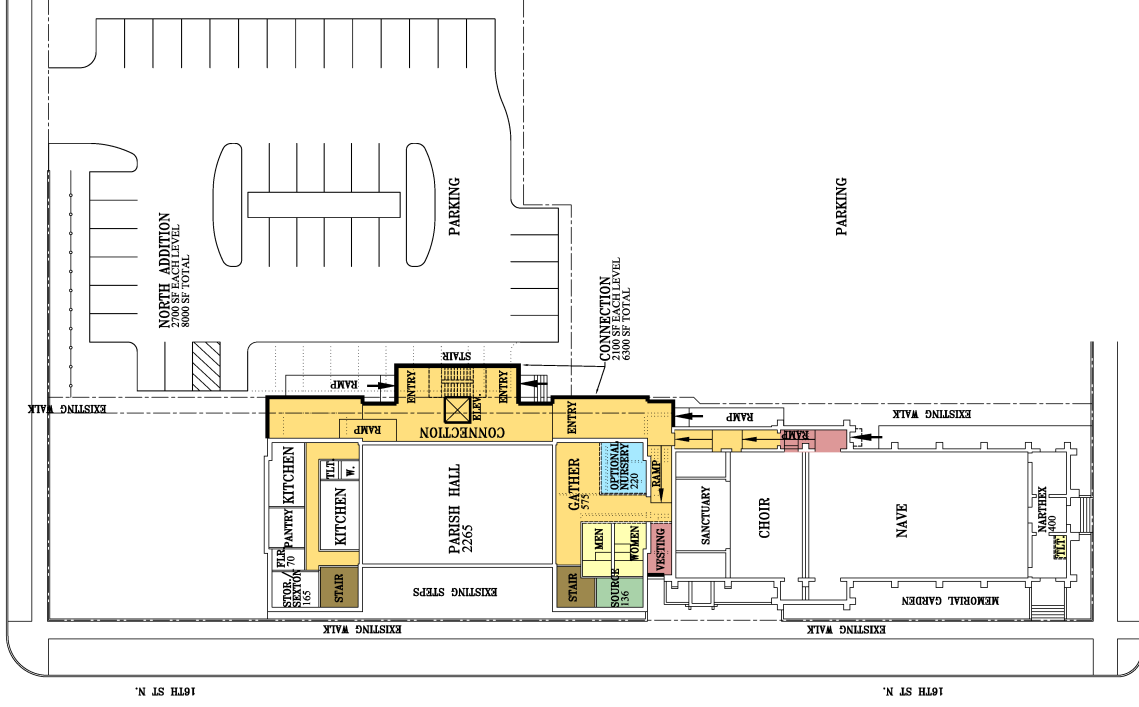

MARKET ST.

MAIN LEVEL



0 10' 20' 40'

LOWER LEVEL



0 10' 20' 40'

PHASE II CAMPUS ENHANCEMENTS

ST. PAUL'S EPISCOPAL CHURCH, WILMINGTON, NORTH CAROLINA

WKWW Architects Charlotte, North Carolina



St. Paul's Episcopal Church

16 North Sixteenth Street

Wilmington, North Carolina 28401

www.spechurch.com (910) 762-4578

Bulletin submissions: bulletin@spechurch.com (Deadline Mondays, 5:00 p.m.)

E-news submissions: e-news@spechurch.com (Deadline Mondays, 5:00 p.m.)

The Right Reverend Robert Skirving, Bishop

The Reverend Caleb J. Lee, Rector

The Reverend Catherine Powell

Ronnie D. Wise, Director of Music and Organist

Richard Rhoads, Assistant Director of Music and Organist

Diane Matz-Kane, Bookkeeper

April Cook, Parish Administrator

St. Paul's Vestry

Layne Dupree	Sally Pope
Ruth Gates	Teresa Singer, Sr. Warden
Angela Green	Tom Sramek, Jr. Warden
Matt Langley	Rhonda Stroud
Steve Martin	Meaghan Thomas
Joan Rosko Miller	Merry Ann Wright
Denise Sheehan, Clerk	
Judy Wilson, Treasurer	